



111A Model Farms Road Winston Hills, NSW

 5  3  2

Welcome Home

Striking in its grandeur, Westons Property & Co. would like to present you with this exquisite brand-new residence ready to welcome its new family.

Capturing style and exceptional proportions throughout this beautifully designed contemporary residence boasts five spacious bedrooms, three bathrooms and a double lock up garage, assuring comfortability for the whole family. Entertain guests effortlessly in the undercover BBQ area, while enjoying the convenience of being within close proximity to quality local schools, family friendly parks, cafes, Winston Hills mall, T-Way & bus stops.

- Boasting an impressive 20-metre wide (approx.) frontage and remarkable street presence.
- Step inside and be greeted with a double storey void, neutral palette & expansive sunlit interiors.
- Open plan kitchen/living room showcases high ceilings throughout and large stacking sliding doors leading to an undercover alfresco with inbuilt stainless-steel barbecue.

RECORD DUPLEX PRICE |
\$1,900,000

Type : Semi Detached
Sold Date : Wednesday, 10th April 2024
Land : 375 m2

Mary Khalil

0432 598 314

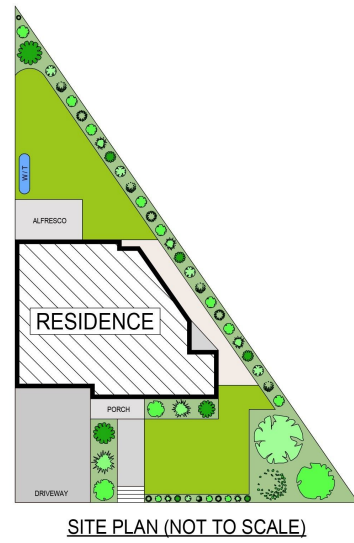
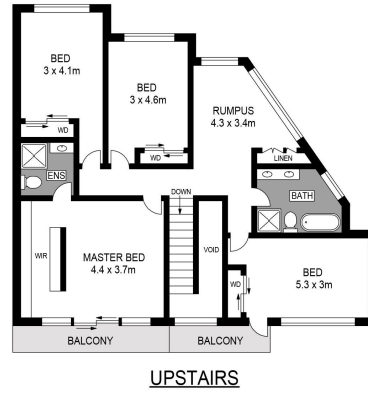
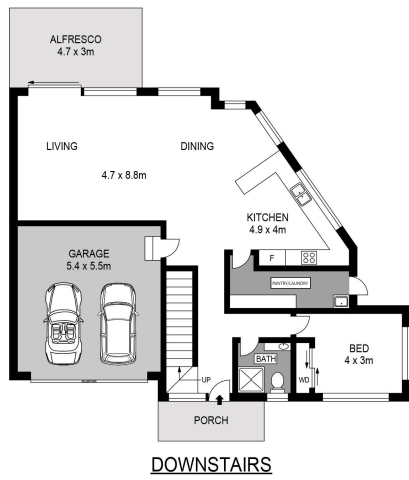

111A Model Farms Road, Winston Hills

111A Model Farms Road, Winston Hills NSW